

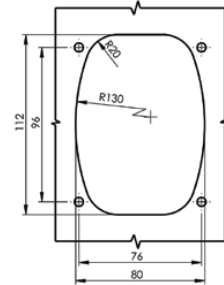

Accessories	 <p>MS866-29</p> <p>Main material: Stainless steel lock body and handle Zamak cam, insert, others are steel Finish: Mirror polished handle and lock body, Bright chrome plated insert housing, other parts in steel with white zinc plated Remark: Default key K53</p> <p>Performance parameter: Handle load tension capability: ϕ200N Cam loading capability: ϕ1000N</p>
Electronic lock	
Handle lock	
Cylinder lock	
Plane lock	
Rod control lock	

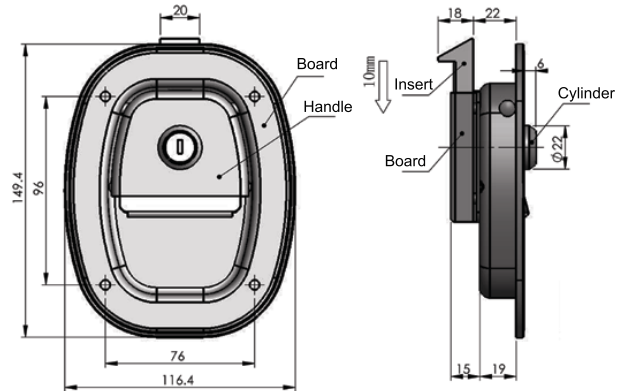

ERP MS866S4A530005

Cut out

Panel lock	 <p>MS983</p> <p>Material and finish: Silk black ZDC housing and handle Application: Pull the handle to make cam rotating, latch toggling and rod stretching to realize opening and closing function. (Default latch DK635) Remark: Default key K640</p> <p>Performance parameter: Handle load tension capability: ϕ845N</p>
Toggle and hook	
Handles	
Door stop	
Hinge	
Seal gasket	

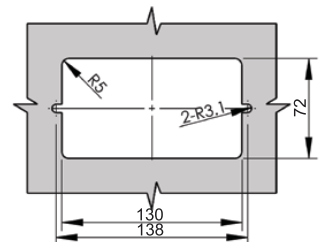
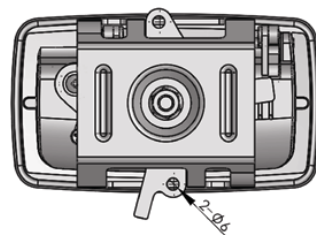
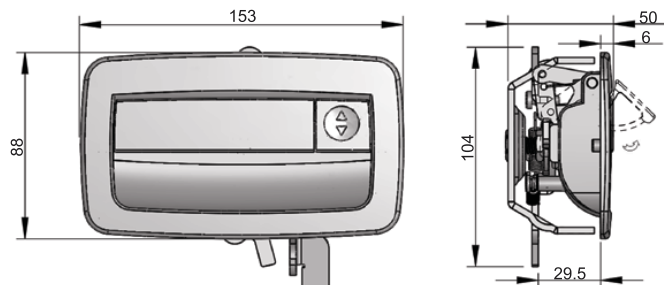

ERP MS983Z2A640002

Cut out