

MS866-5E



Main material and finish: Silk black steel cup, handle, chrome plated ZDC insert, stainless steel cover

Application: The drawing shows in locked position, turn the key and open insert, the handle pulls 20° up to open buckle by anti-loose structure, it can automatic reset.

Remark: There is catcher available, default one is without catcher. Default key is K49, key different available

Performance parameter:
Handle load tension capability: $\phi 145N$

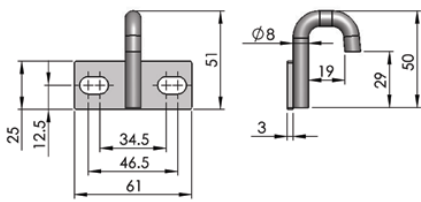

Latch 1



Latch 2

The dimension of Latch 1 and Latch 2 are the same, the welding direction is different

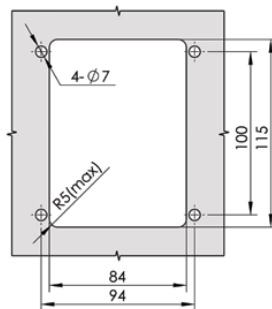

Cut out

ERP

MS866F1A490001

Accessories

Electronic lock

Handle lock

Cylinder lock

Plane lock

Rod control lock

Panel lock

Toggle and hook

Handles

Door stop

Hinge

Seal gasket