

	Black powder coated	Pocked black powder coated	Bright chrome-plated	Nanometer painted
ERP	CL222Z1A001	CL222Z1B001	CL222Z3A001	CL222Z2B002

CL222



Main material and finish: ZDC hinge, nickel-plated steel pin, PA bushing
Application: Opening angle 180°

Performance parameter:
Maximum static load
Radial load: 1675N
Axial load: 2000N

Accessories

Electronic lock

Handle lock

Cylinder lock

Plane lock

Rod control lock

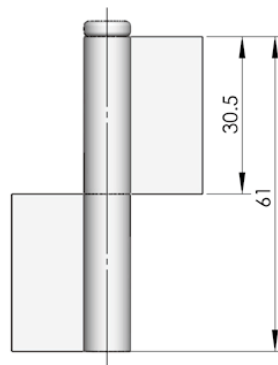
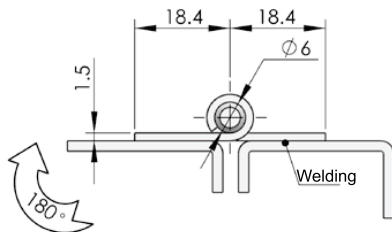

ERP	CL223F3D001
-----	-------------

CL223



Main material and finish: White zinc plated steel hinge leaf
Application: Opening angle 180°

Performance parameter:
Maximum static load
Radial load: 390N
Axial load: 1260N

Panel lock

Toggle and hook

Handles

Door stop

Hinge

Seal gasket